

## Parameter Of Standard Neodymium Pot Magnets With External(Male) Threaded Stud

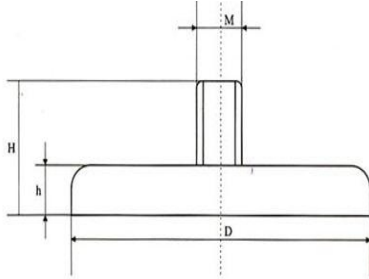

Item Code	Dimension(mm)				Force(kgs)	Weight(g)
	D	M	H	h		
NdFeB-C10	10	3	12	5	2.2	3.5
NdFeB-C12	12	3	13	5	3.2	5
NdFeB-C16	16	4	13	5	5.5	7.5
NdFeB-C20	20	4	15	7	9	14
NdFeB-C25	25	5	17	8	22	26
NdFeB-C32	32	6	18	8	34	44
NdFeB-C36	36	6	19	8	41	53
NdFeB-C42	42	8	20	9	68	84
NdFeB-C48	48	8	24	11.5	81	138
NdFeB-C60	60	8	30	15	113	293
NdFeB-C75	75	10	34	18	164	542

**Note:** common standard neodymium countersunk cup magnets are with grade of N35 and Nickel coating unless customers have other requirement. Ferrite(ceramic) magnets can used on the cup magnets in stead of neodymium magnets.