

## Parameters of standard common flat neodymium pot magnets with threaded through hole

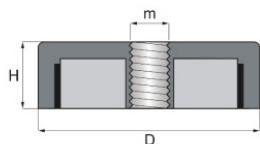

Items Code	Dimension(mm)				Magnetic Force(kg)
	D(mm)	M	D2(mm)	H(mm)	
NdFeB-H-16	16	M3	6.5	5	7
NdFeB-H-20	20	M4	8	7	10
NdFeB-H-25	25	M5	9	8	20
NdFeB-H-32	32	M5	9	8	35
NdFeB-H-36	36	M6	11	8	42
NdFeB-H-42	42	M6	11	9	68
NdFeB-H-48	48	M8	15	11.5	75
NdFeB-H-60	60	M8	15	15	112
NdFeB-H-75	75	M10	18	18	164

**Note:** common standard neodymium countersunk cup magnets are with grade of N35 and Nickel coating unless customers have other requirement. Ferrite(ceramic) magnets can used on the cup magnets in stead of neodymium magnets.